

PRECISION MOLD

A Premier Supplier of Precision Machined Castings to Chrysler Selected
FACILITIES PLANNING SERVICES LLC



Precision Mold cast and machined a critical frame component for the popular Chrysler van. When the facility was completed in 1995, they were not able to produce product at the required rate for Chrysler. Millions of dollars and many man years were invested trying to resolve this challenge. Unresolved, Chrysler considered building a second facility costing many millions of dollars. A May 1995 issue of the Wall Street Journal described this challenge at Precision Mold, as the reason the Chrysler stock had dropped.

Given the go ahead, FPS resolved the challenge in less than four months with less than a half million dollars in capital equipment expenditures. Most of this success was due to improved methods and procedures. Labor requirements actually dropped by over 30%. This dramatic FPS success at Precision Mold / Chrysler has been repeated at Honda, Toyota, CMI, Volvo, and many other automotive and aviation facilities worldwide.

Before you commission an architect or a developer to design a manufacturing or distribution facility, or even a property agent to find one, there is an essential step that needs to be taken. That is to ensure that the facility will, in fact, meet the needs of the desired operations. To achieve this objective, FPS utilized their proprietary FORM scientific approach in development since 1983. This path to develop the optimum functional design and outlining how it will operate is critical for up front decisions.

Established in 1972, FPS has extensive materials logistics planning and solution implementation experience in manufacturing and distribution operations. FPS is internationally known for professional facilities design, process re-engineering, flow & capacity analysis, productivity solutions, and management consulting.

www.FacilitiesPlan.com

CHG	DESCRIPTION	BY	DATE

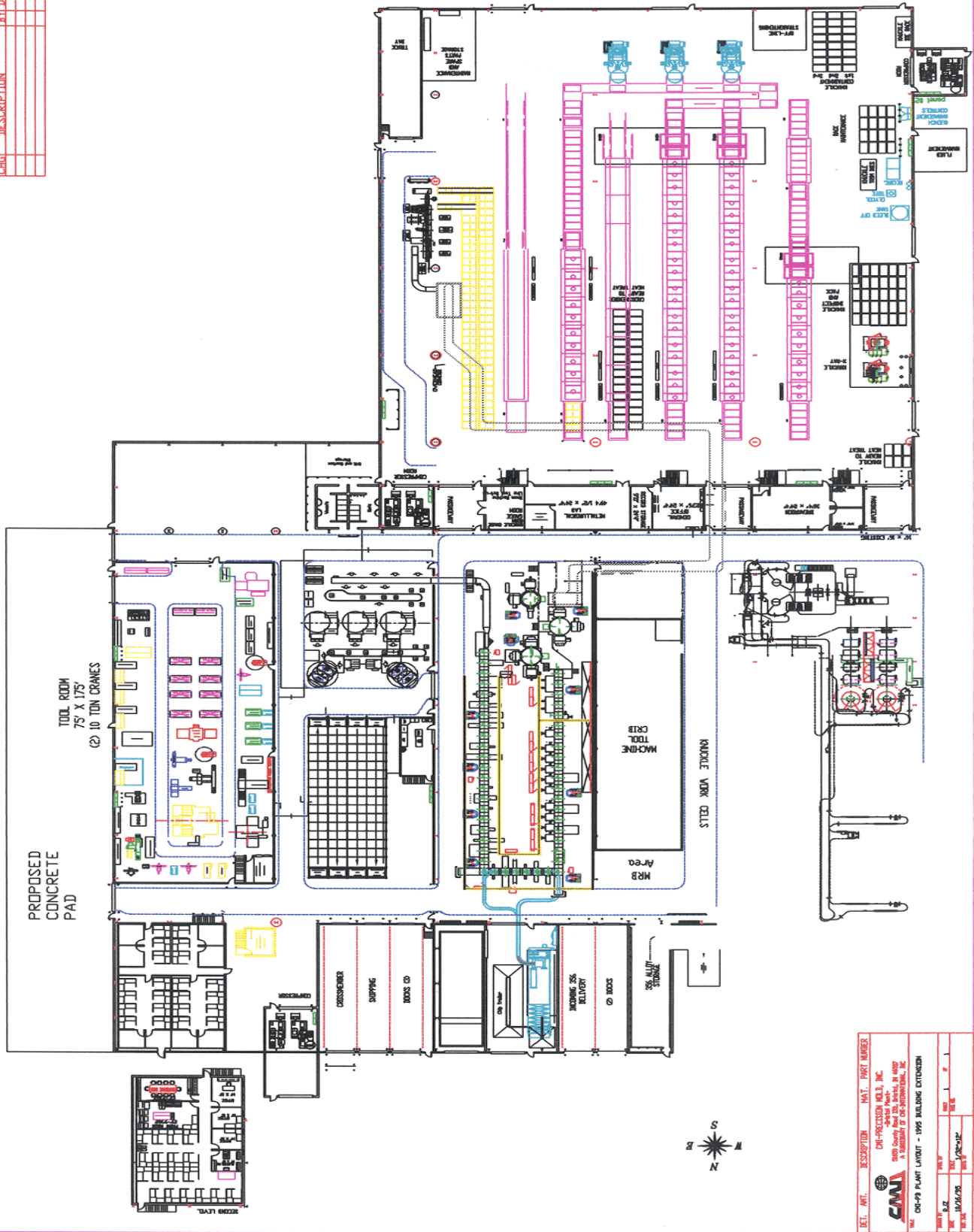

DET.	MT.	DESCRIPTION	MAT.	PART NUMBER

CH-PRODUCTION MFG., INC.
 500 South Park St.
 WILMINGTON, NC 28402
 A DIVISION OF CH-INTERNATIONAL, INC.

CH-P2 PLANT LAYOUT - 1995 BUILDING EXTENSION

DATE	BY	CHKD	APP'D
10/26/05			